

# How Do You MAKE ...

## PINCH CLEATS

*Pinch cleats* are used to easily attach a cabinet or overhang or similar object to a wall surface. The wall must be rigid for this technique to work. For instance, a soft-covered flat is generally unacceptable unless it has been specially framed to accommodate the cleat.

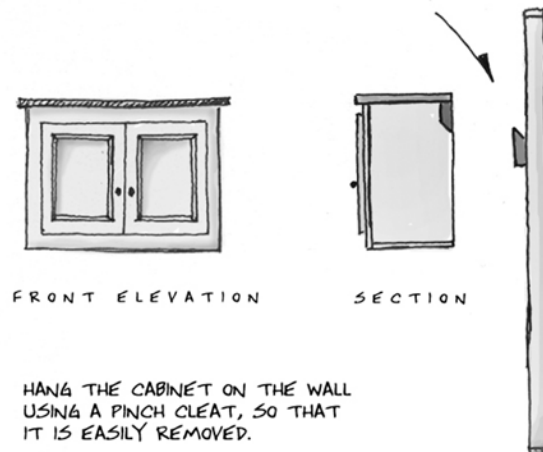

HANG THE CABINET ON THE WALL USING A PINCH CLEAT, SO THAT IT IS EASILY REMOVED.

THE OPPOSING ANGLES DRAW THE TWO HALVES OF THE CLEAT TOGETHER.

The basic principle involved is to lock together two boards cut at an angle. The piece will be hung securely from the top, as long as no one pushes up on it and disengages the cleat. When hanging, the bottom of the cabinet presses hard against the wall, which is why the hanging surface must be sturdy and rigid. There are lots of fun ways to use this technique on different types of scenery. It is great for quick assemblies.

